

CIRCUIT DIAGRAM

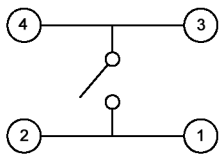

P.C.B. LAYOUT

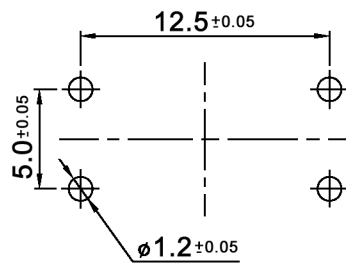

Compliance: RohS II (2011/65/EU)

Tolerances: max. ±0.2mm		Date	Name	<h1>TSE 21 x</h1>	
		05/10	dr		
Washable	08/15	dr	<h1>30 20 98</h1>	Page	
Revised	02/13	dr		<h1>knitter-switch</h1>	1/2
IP rating	04/12	dr			
Modifications	Date	Name			

Specifications:

Contact rating: 50mA, 50V DC  
 Contact resistance: 100mOhm max.  
 Insulation resistance: 100MOhm min. at 100V DC for 1 minute +/-5sec.  
 Dielectric strength: 250V AC (50/60Hz) for 1 minute  
 Operating temperature: -40°C to +85°C  
 Storage temperature: -40°C to +85°C  
 Soldering conditions: max. 260°C, max. 5sec.  
 Travel: 0.40 +/-0.20mm  
 Material: Stem: high-temp. thermoplastic nylon UL94V-0  
 Cover: stainless steel  
 Seal: silicone rubber, molded black  
 Contact: stainless steel, silver plated  
 Terminal: brass, silver plated  
 Base: high-temp. thermoplastic LCP, molded black  
 IP rating: IP 67  
 Washable, tested for 1 minute in 5cm depth in fluorocarbon at 50°C

x	Operating force (gf)	Mechanical life	Color of stem
N	160 +/-50	1 000 000 cycles	brown
R	260 +/-50	1 000 000 cycles	red
W	320 +/-80	300 000 cycles	white
Y	520 +/-130	300 000 cycles	yellow

Compliance: RohS II (2011/65/EU)

Tolerances: max. ±0.2mm	Date	Name	<b>TSE 21 x</b>
	05/10	dr	
	<b>knitter-switch</b>		<b>30 20 98</b>
			Page
			2/2
Modifications	Date	Name	